

# PermaBase<sup>®</sup> BRAND

## 1/4" Cement Board Underlayment



Perma  
**BASE**<sup>®</sup>  
BRAND

National   
Gypsum<sup>®</sup>

# PermaBase<sup>®</sup> BRAND

## 1/4" Cement Board Underlayment

### Description

1/4" PermaBase<sup>®</sup> BRAND Cement Board is used as an underlayment for ceramic tile on floors, countertops, tub decks and outdoor kitchen counters.

1/4" PermaBase Cement Board is a rigid substrate made of Portland cement, aggregate and glass mesh that provides an exceptionally hard, durable surface that is able to withstand prolonged exposure to moisture.

PermaBase offers a competitive advantage over similar products on the market with its patented EdgeTech<sup>®</sup> technology. The tapered, double-wrapped edge design allows for closer nail or screw application to the edge while helping prevent damage in transit and on the jobsite.

### Features/Benefits

- The 1/4" thickness eliminates the need to modify adjacent thresholds when abutting to carpet, wood flooring or other common flooring materials.
- PermaBase resists the growth of mold and mildew achieving a panel score of 10, the highest score possible, per ASTM D 3273.\*

- 1/4" PermaBase can be used for counters and is ideal for applying directly over laminate or other wood surface countertops.
- PermaBase has a lower moisture absorption rate than other backerboards, which ensures an accurate open time and a better bond.
- Double-wrapped edges allow for closer fastening of nails or screws without crumbling or spinout. It is extremely durable in transit and on the jobsite, while also easier to handle.
- Can be cut using a standard utility knife instead of specialty tools or expensive power tools.
- Homogeneous core has fewer voids and provides a very clean score and snap.
- PermaBase is highly moisture resistant and will not rot, swell or disintegrate when exposed to moisture.
- Compatible with all brands of thinsets and grouts.
- 1/4" PermaBase carries a 30-year limited warranty for interior applications.

\* When tested by an independent laboratory per ASTM D 3273 ("Standard Test Method for Resistance to Growth of Mold on the Surface of Interior Coatings in an Environmental Chamber"), PermaBase achieved a panel score of 10, the highest score possible, indicating no mold growth under the laboratory test conditions. The use of PermaBase in actual installations may not produce the same results as were achieved in controlled laboratory conditions. No material can be considered "mold proof," nor is it certain that any material will resist mold indefinitely.

### Tape & Screws

National Gypsum recommends the use of PermaBase Tape and PermaBase Screws to complete your installation.



### Corporate Headquarters

National Gypsum Company  
2001 Rexford Road  
Charlotte, NC 28211  
Phone: (704) 365-7300  
Web: [nationalgypsum.com](http://nationalgypsum.com)  
[nationalgypsum.com/espanol](http://nationalgypsum.com/espanol)

### Technical Information

Phone: (800) NATIONAL  
(800) 628-4662  
Fax: (800) FAX-NGC1  
(800) 329-6421

### COMPARISON CHART

	1/4" PermaBase	1/4" Fiber Cement
Moisture absorption when tested according to ASTM C 473	6-8%	25-35%
Permitted for use in exterior applications	Yes	No
Can be cut with standard utility knife	Yes	No
Organic cellulose fiber reinforcement	No	Yes
Need to wipe entire surface of board with damp sponge prior to applying setting compounds.	No	Yes
Expansion joints needed every 15'	No	Yes
Interior Warranty	30 years	20 years
Can use both standard and latex-modified thin-sets	Both	Latex-Modified Only
Flame Spread/Smoke Dev. ASTM E 84	0/0	0/5
Fungus Resistance ASTM G 21	No Growth	No Growth
Mold Growth on Surface ASTM D 3273	No Growth	No Growth

### Countertop

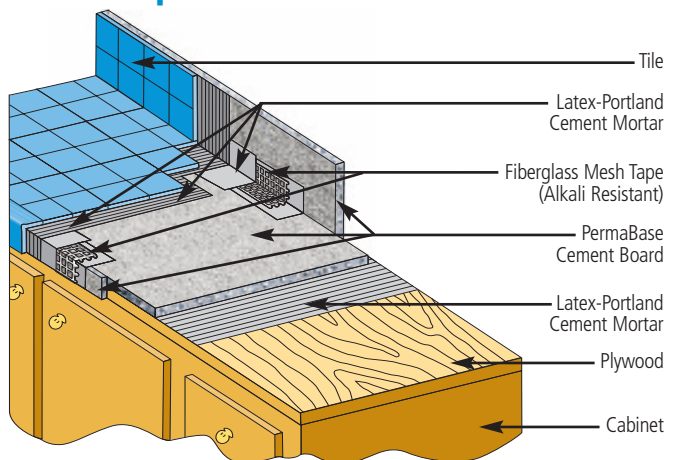

### Floor Underlayment

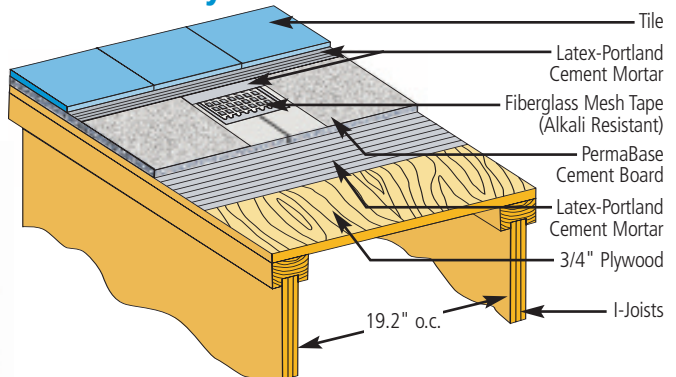

Excellence Across The Board<sup>®</sup>